

# H3

## A Condominium

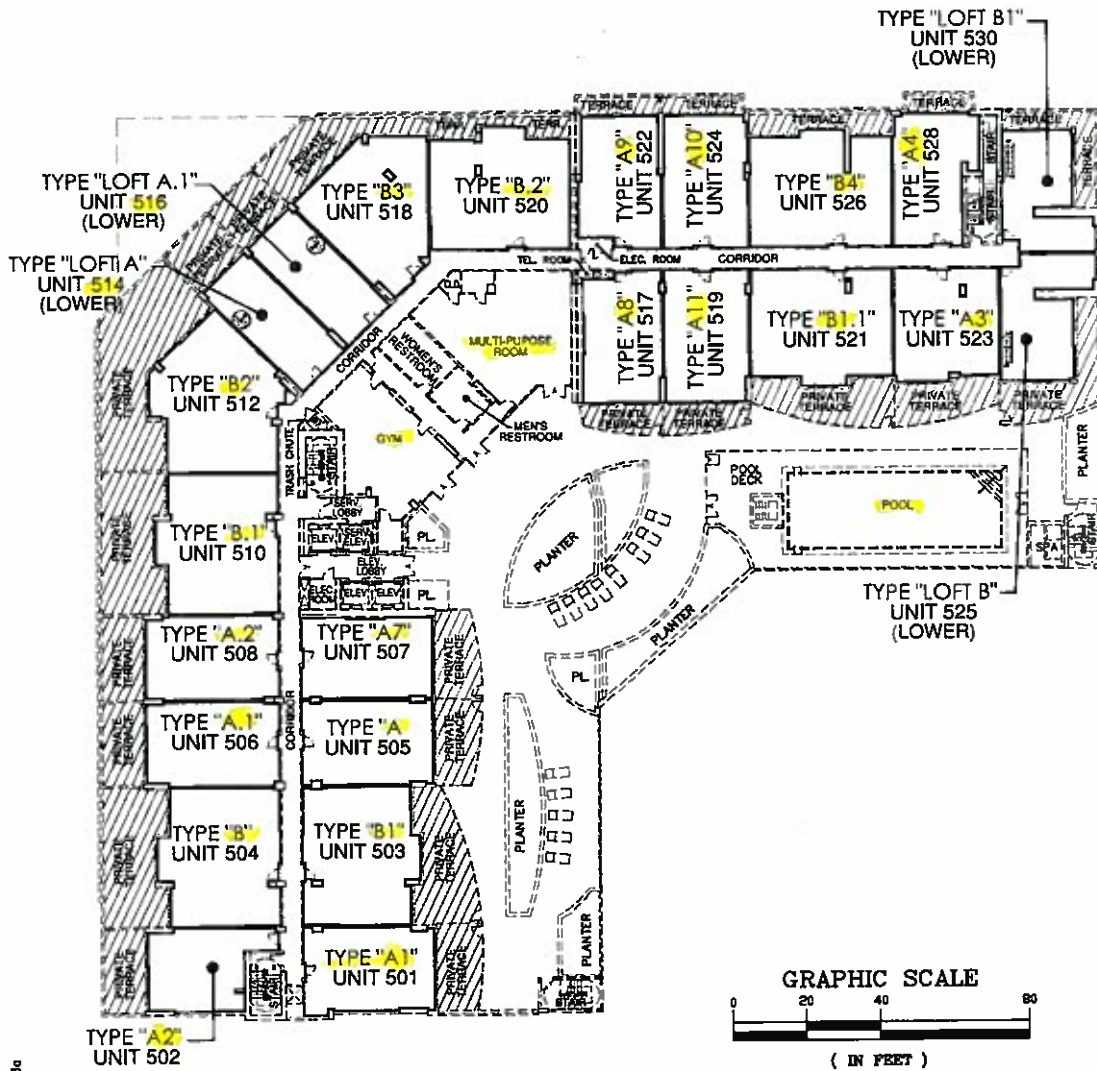

Cad No. 121321F    DWG BY: OJO    Date Printed: 1/14/13 7:03a

**LEGEND:**

- CONDOMINIUM UNIT BOUNDARY LINE
- - - COMMON ELEMENT
- LIMITED COMMON ELEMENTS
- ELEV.      ELEVATOR
- ELEC.      ELECTRIC ROOM



**NOTES:**

For a complete description of the unit boundaries shown hereon, refer to the Declaration of Condominium.

All improvements are proposed and subject to change without notice.

All Terraces and/or Balconies are Limited Common Elements.

Elevators, Columns, Chases, Trash Chutes, Stairways, Mechanical Rooms, Electrical Rooms, and corridor are Common Elements.

Tenant storages are Common Elements and shall become Limited Common upon being assigned to individual units in accordance with the Declaration of the Condominium.

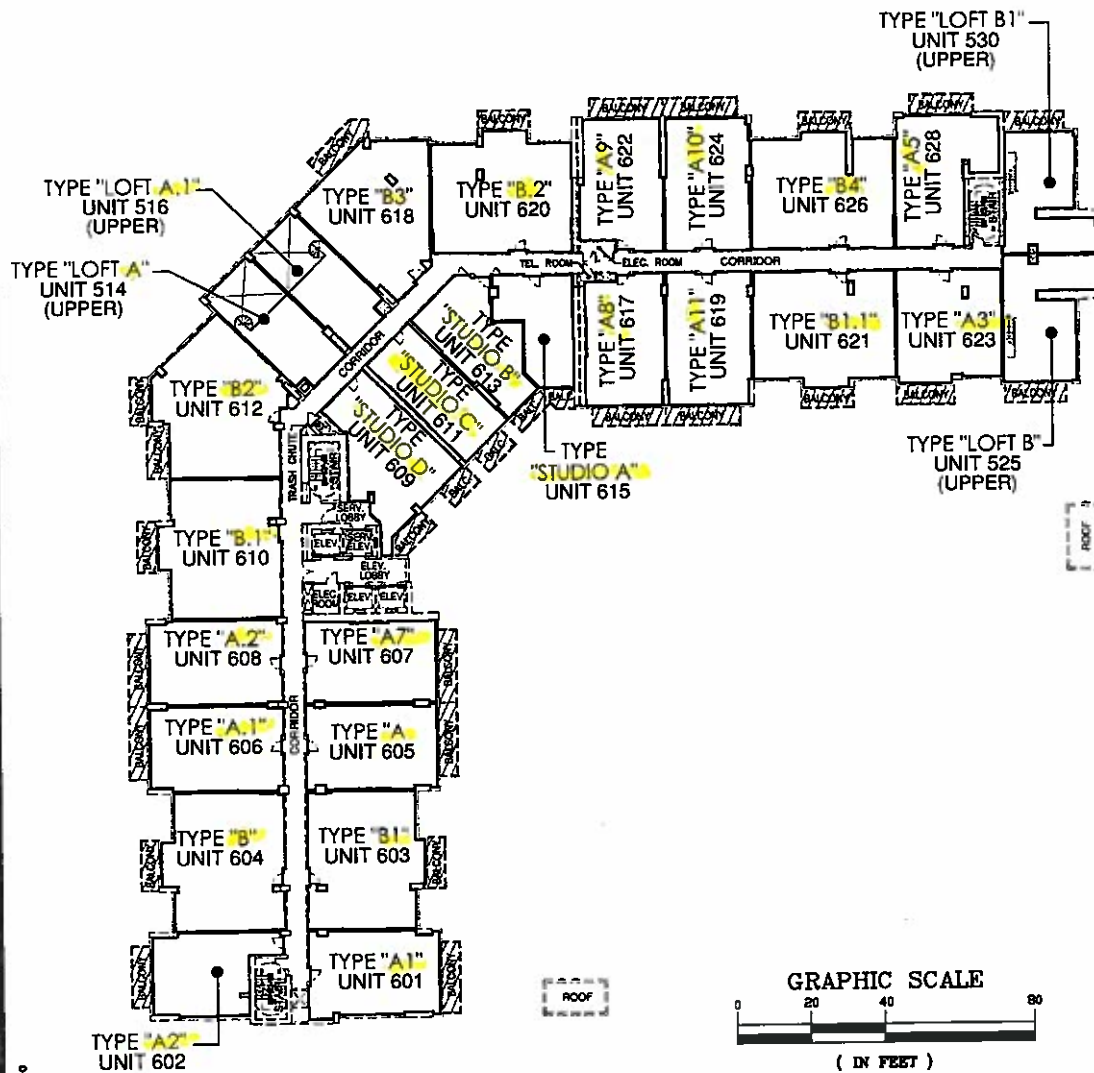

# H3

## A Condominium



Date Printed: 1/14/73 7:03a  
 DWG BY: OJD  
 Cd No. 121321F

**LEGEND:**

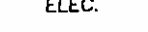
- CONDOMINIUM UNIT BOUNDARY LINE
- - - COMMON ELEMENT
-  LIMITED COMMON ELEMENTS
-  ELEV. ELEVATOR
-  ELEC. ELECTRIC ROOM



**NOTES:**

For a complete description of the unit boundaries shown hereon, refer to the Declaration of Condominium.

All improvements are proposed and subject to change without notice.

All Terraces and/or Balconies are Limited Common Elements.

Elevators, Columns, Chases, Trash Chutes, Stairways, Mechanical Rooms, Electrical Rooms, and corridor are Common Elements.

Tenant storages are Common Elements and shall become Limited Common upon being assigned to individual units in accordance with the Declaration of the Condominium.

# H3

## A Condominium

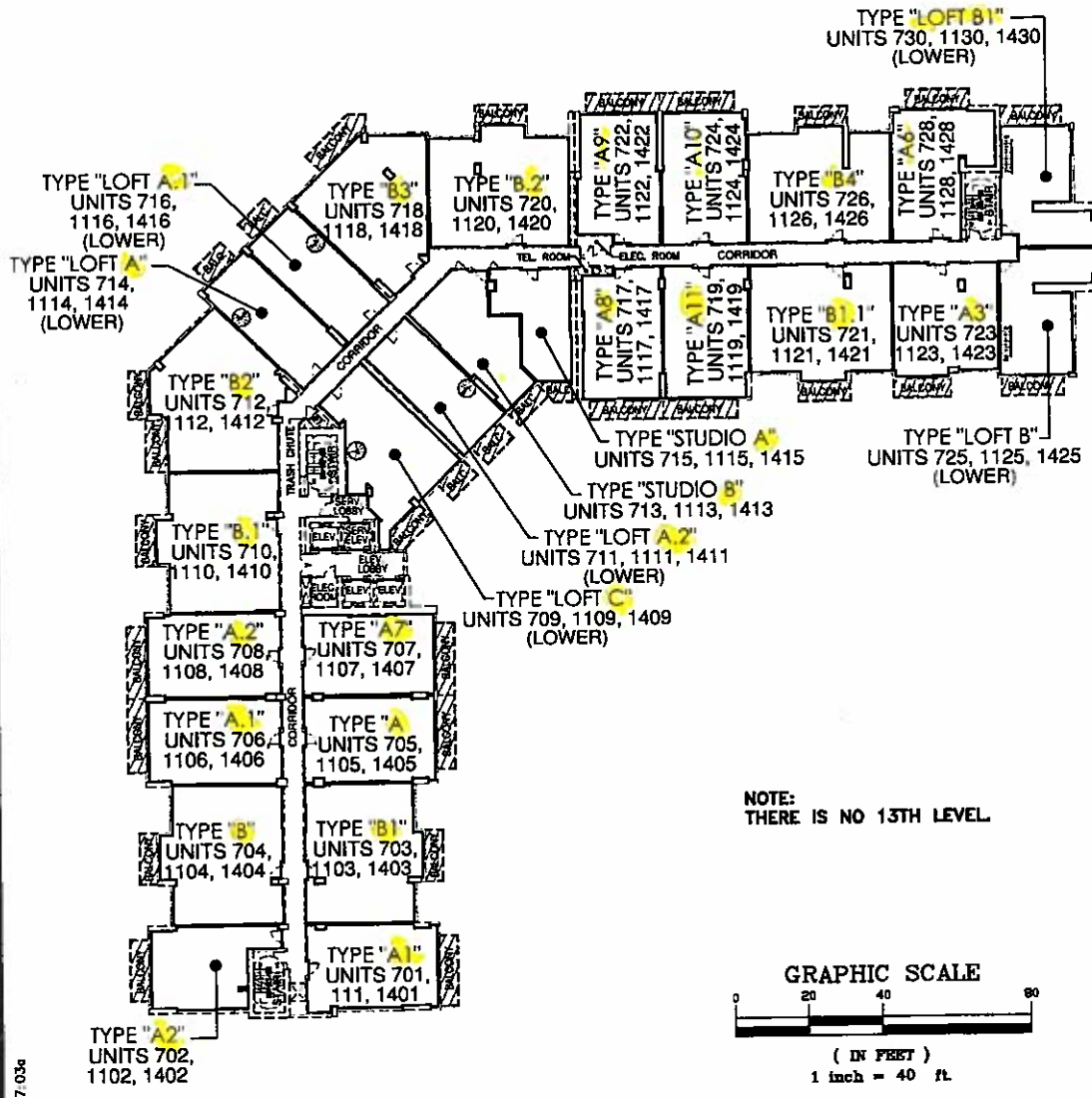

Cad No. 12132 F  
 DWG BY: OJD  
 Date Printed: 1/14/13 7:03a

- LEGEND:**
- CONDOMINIUM UNIT BOUNDARY LINE
  - COMMON ELEMENT
  - LIMITED COMMON ELEMENTS
  - ELEVATOR
  - ELECTRIC ROOM



**NOTES:**

For a complete description of the unit boundaries shown hereon, refer to the Declaration of Condominium.

All improvements are proposed and subject to change without notice.

All Terraces and/or Balconies are Limited Common Elements.

Elevators, Columns, Chases, Trash Chutes, Stairways, Mechanical Rooms, Electrical Rooms, and corridor are Common Elements.

Tenant storages are Common Elements and shall become Limited Common upon being assigned to individual units in accordance with the Declaration of the Condominium.

# H3

## A Condominium

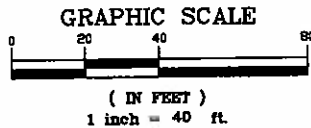
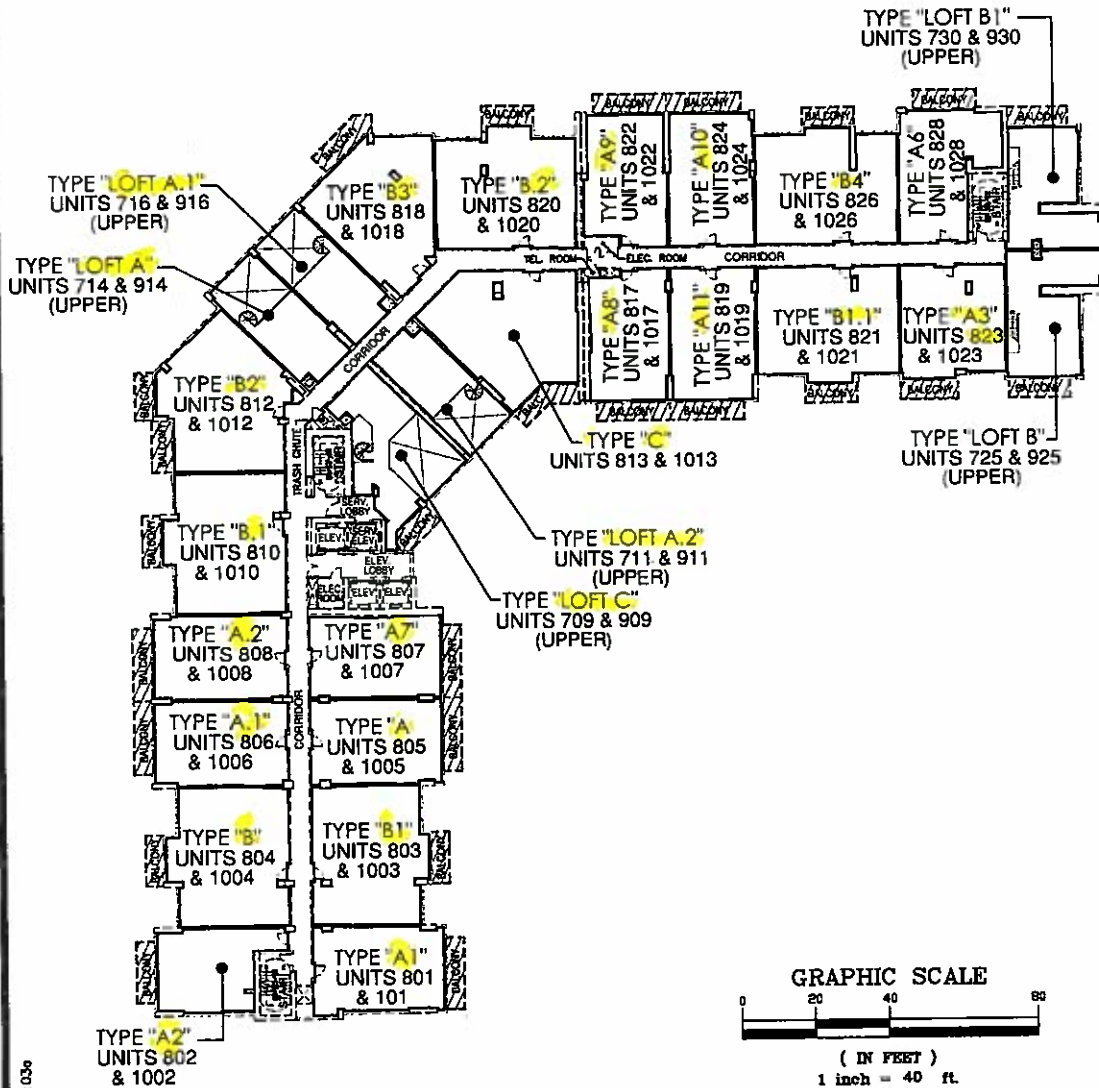

Date Printed: 1/14/13 7:03a  
 DWG BY: OJO  
 Cad No. 121321F

- LEGEND:**
- CONDOMINIUM UNIT BOUNDARY LINE
  - COMMON ELEMENT
  - LIMITED COMMON ELEMENTS
  - ELEV. ELEVATOR
  - ELEC. ELECTRIC ROOM



**NOTES:**

For a complete description of the unit boundaries shown hereon, refer to the Declaration of Condominium.

All improvements are proposed and subject to change without notice.

All Terraces and/or Balconies are Limited Common Elements.

Elevators, Columns, Chases, Trash Chutes, Stairways, Mechanical Rooms, Electrical Rooms, and corridor are Common Elements.

Tenant storages are Common Elements and shall become Limited Common upon being assigned to individual units in accordance with the Declaration of the Condominium.

# H3

## A Condominium

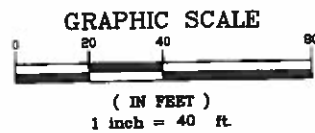
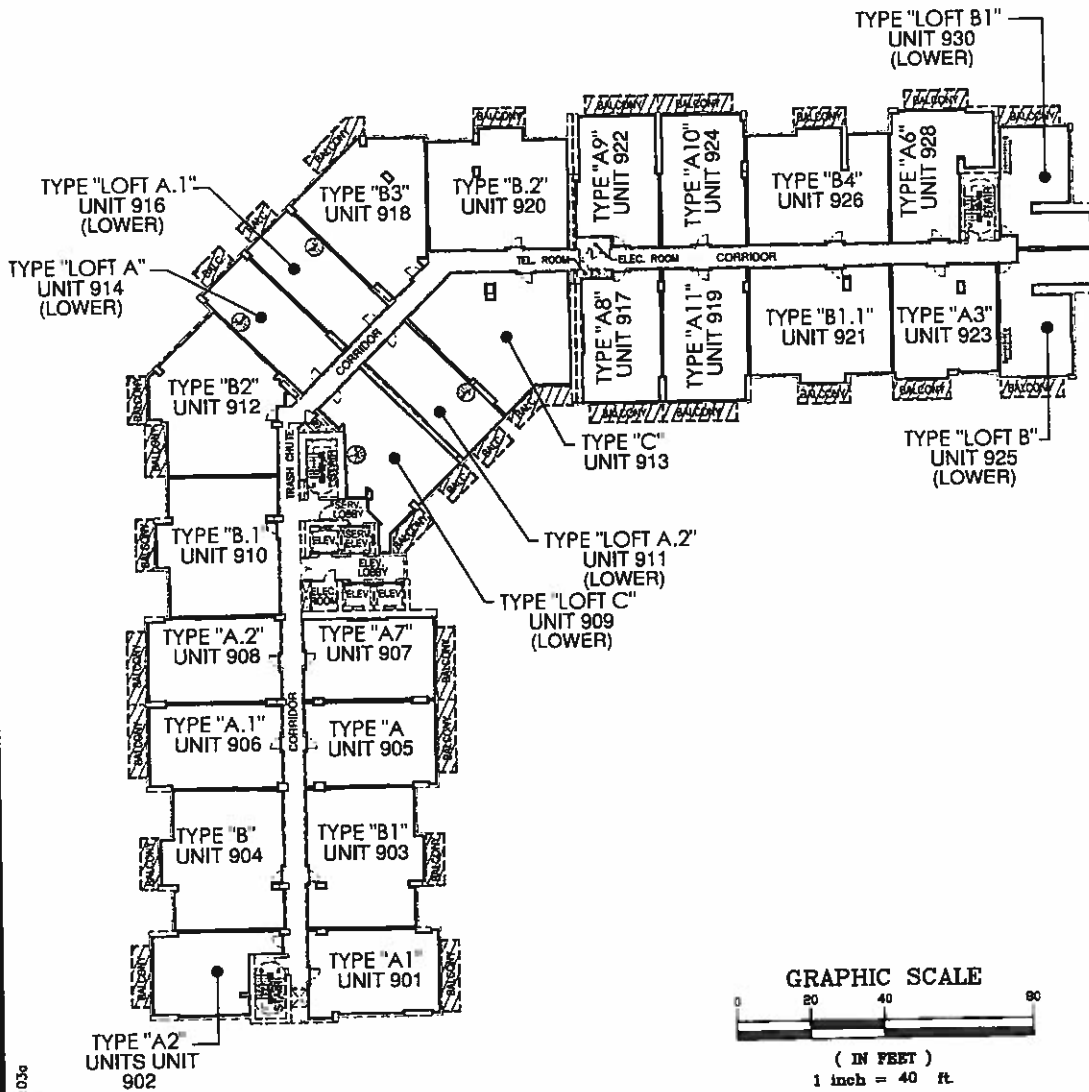

Date Printed: 1/14/13 7:03a  
 DWG BY: QJO  
 Cad No. 121321F

**LEGEND:**

- CONDOMINIUM UNIT BOUNDARY LINE
- - - COMMON ELEMENT
- LIMITED COMMON ELEMENTS
- ELEV. ELEVATOR
- ELEC. ELECTRIC ROOM



**NOTES:**

For a complete description of the unit boundaries shown herein, refer to the Declaration of Condominium.

All improvements are proposed and subject to change without notice.

All Terraces and/or Balconies are Limited Common Elements.

Elevators, Columns, Chases, Trash Chutes, Stairways, Mechanical Rooms, Electrical Rooms, and corridor are Common Elements.

Tenant storages are Common Elements and shall become Limited Common upon being assigned to individual units in accordance with the Declaration of the Condominium.

# H3

## A Condominium

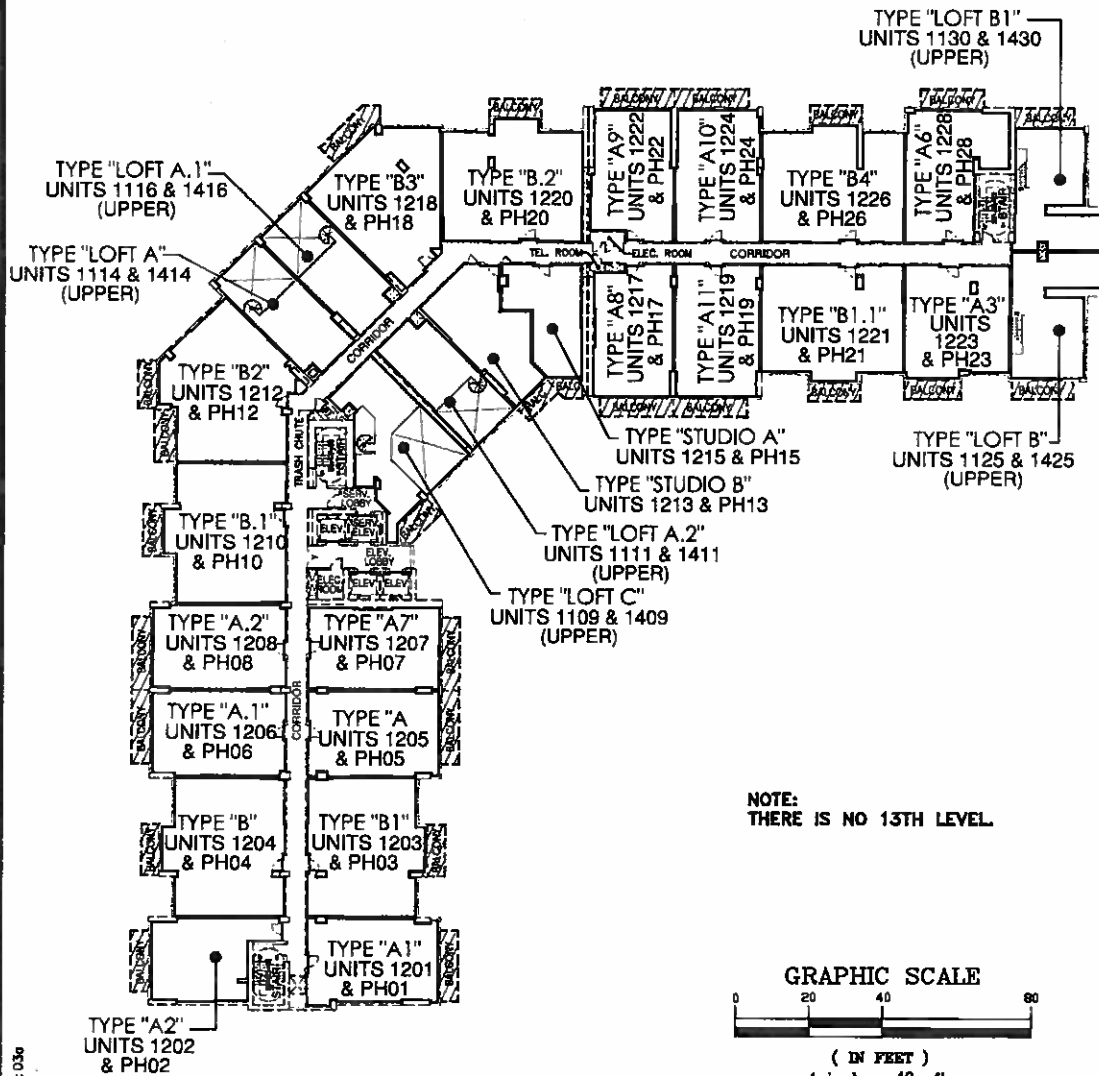

Cad No. 121321F  
 DWG BY: CJO  
 Date Printed: 1/14/13 7:03a

**LEGEND:**

- CONDOMINIUM UNIT BOUNDARY LINE
- - - - COMMON ELEMENT
- LIMITED COMMON ELEMENTS
- ELEV. ELEVATOR
- ELEC. ELECTRIC ROOM



**NOTES:**

For a complete description of the unit boundaries shown hereon, refer to the Declaration of Condominium.

All improvements are proposed and subject to change without notice.

All Terraces and/or Balconies are Limited Common Elements.

Elevators, Columns, Chases, Trash Chutes, Stairways, Mechanical Rooms, Electrical Rooms, and corridor are Common Elements.

Tenant storages are Common Elements and shall become Limited Common upon being assigned to individual units in accordance with the Declaration of the Condominium.